

A-A (1 : 1)

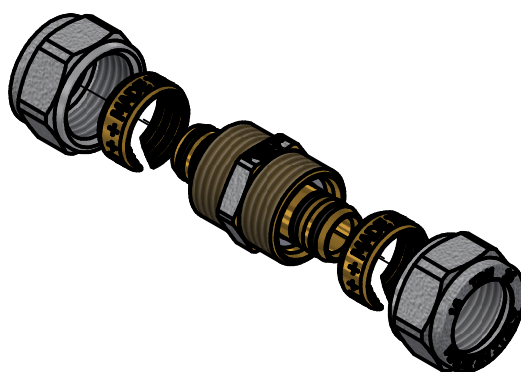
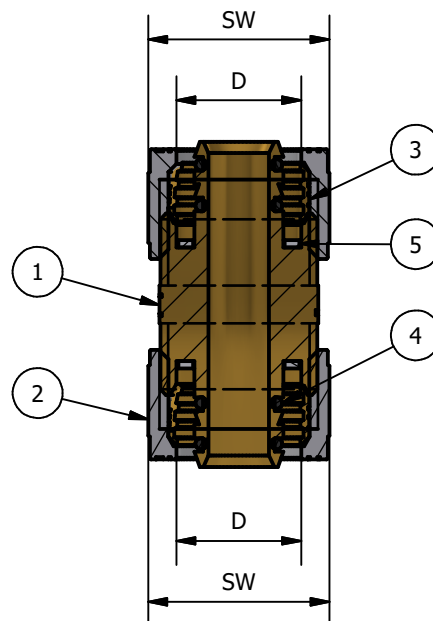
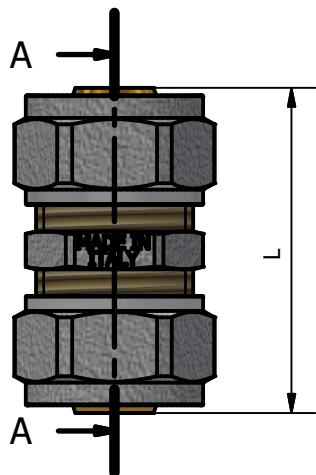

TDM CODE	SIZE	L	D	SW
1040 16	16	42	16	24
1040 18	18	45	18	27
1040 20	20	47	20	30
1040 26	26	55	26	36
1040 32	32	65	32	42

N°	DESCRIPTION	MATERIAL
1	BODY	CW 617N EN12165
2	LOCKING NUT	CW 617N EN12165
3	CUT RING	CW 614N EN12168
4	O-RING	EPDM PEROX 681-1
5	ISOLATOR	P.T.F.E.

CONFORMITY
1) DM 174 6 APRIL 2004
2) UNI EN 10954-2
3) UNI EN 1254-3
4) UNI EN ISO 228-1

WORKING PRESSURE MAX	10 BAR
WORKING TEMPERATURE MIN-MAX	-20°C/110°C

00	Prima emissione	Delaini M.	27/02/2012
Rev.	Nota Revisione	Approvatore	Data Approvazione
Toll Gen:	JS13	Stato sup.:	Giallo Nichelato
Filetto:	-	Note tecniche:	
Peso lavorato:	Peso grezzo:	N° stampo:	
Materiale:		Disegnatore:	Data: 27/02/2012
		Delaini P.	
TDM Brass s.r.l via Artigiani , 7-9 25030 Maclodio BS Italy tel +39 030 9972217 fax 030 9787089 www.tdmbrass.it email info@tdmbrass.it			

Codice: 1040 scheda

Descrizione: Double straight fitting



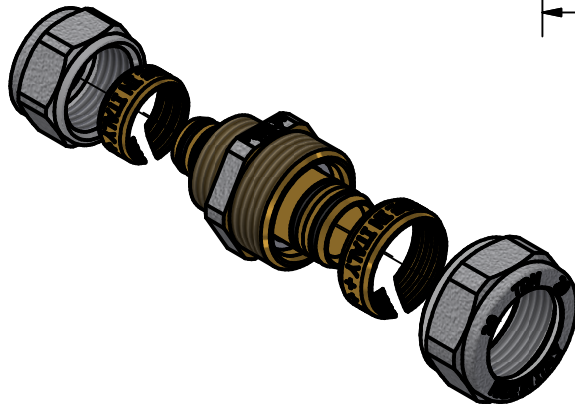
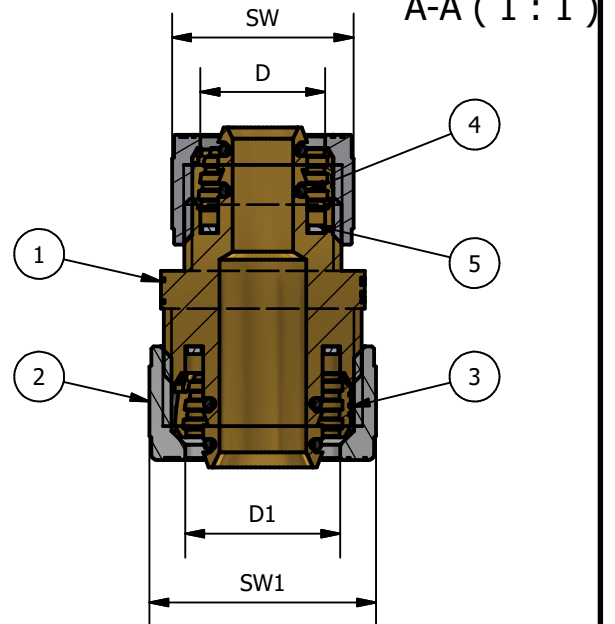
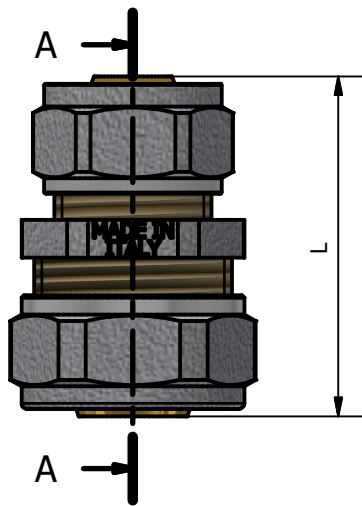

TDM CODE	SIZE	L	D	D1	SW	SW1
1040 1620	16x20	45,5	16	20	24	30
1040 2516	25x16	49	16	25	24	36
1040 2616	26x16	49	16	26	24	36
1040 2520	25x20	51,5	20	25	30	36
1040 2620	26x20	51,5	20	26	30	36
1040 3225	32x25	61	25	32	36	42
1040 3226	32x26	61	26	32	36	42

N°	DESCRIPTION	MATERIAL
1	BODY	CW 617N EN12165
2	LOCKING NUT	CW 617N EN12165
3	CUT RING	CW 614N EN12168
4	O-RING	EPDM PEROX 681-1
5	ISOLATOR	P.T.F.E.

CONFORMITY
1) DM 174 6 APRIL 2004
2) UNI EN 10954-2
3) UNI EN 1254-3
4) UNI EN ISO 228-1

WORKING PRESSURE MAX	10 BAR
WORKING TEMPERATURE MIN-MAX	-20°C/110°C

00	Prima emissione	Delaini M.	27/02/2012
Rev.	Nota Revisione	Approvatore	Data Approvazione
Toll Gen:	JS13	Stato sup.:	Giallo Nichelato
Filetto:	-	Note tecniche:	
Peso lavorato:	Peso grezzo:	N° stampo:	
Materiale:		Disegnatore:	Data: 27/02/2012
		Delaini P.	
Codice: 1040 sfalsato scheda			
Descrizione: Doudle straight fitting reducing			
TDM BRASS Italian Fittings			
TDM Brass s.r.l via Artigiani , 7-9 25030 Maclodio BS Italy tel +39 030 9972217 fax 030 9787089 www.tdmbrass.it email info@tdmbrass.it			